

**FREE AIRFARE**  
LIMITED TIME OFFER. CALL FOR DETAILS.



14 DAYS • 27 MEALS • BUCHAREST > BUDAPEST

## GEMS OF EASTERN EUROPE

Romania • Bulgaria • Serbia • Croatia • Hungary

**Departure Date:** June 6 – 19, 2027

Sail the Danube through five captivating countries on a 14-day journey filled with cultural treasures.

Visit a Hungarian horse farm, share lunch with a Croatian family, and tour Belgrade before enjoying a Serbian folklore show. Explore Lepenski Vir, taste Bulgarian wines, discover Bucharest's highlights, and spend three nights in Transylvania, including a visit to Dracula's Castle.

**CSB** COMMUNITY  
STATE BANK

*select*  
**50**  
20 YEARS



### DAY 1 Depart the USA

Depart the USA on your overnight flight to Bucharest, Romania.

### DAY 2 Bucharest, Romania

Upon arrival, you will be met at the airport and transferred to your hotel. The day is at leisure to begin discovering this historic city on your own.

### DAY 3 Bucharest – Brasov

Get ready for the start of your Transylvanian adventure! Depart by coach for the town of Brasov, a pleasant mix of traditional medieval charm and modern city life, in the center of Transylvania. En route, visit the world renowned 14th-century Bran (Dracula's) Castle, perched atop a hill, looking like it's from the pages of a fairytale book. Explore the castle, believed to be home to Vlad the Impaler, discover the secrets held within the walls, and decide for yourself if the dark tales are truth or legend! [Meals: B, L](#)

### DAY 4 Brasov

A walking tour includes the St Nicholas Church and a visit of the First Romanian School Museum, leading centers of the Romanian community. The museum houses the oldest Romanian bible, printed on goats' skin. Stroll through Brasov's historical medieval center, learning of its German heritage, and visit Black Church, the largest Gothic church east of Vienna. [Meal: B](#)



### DAY 5 Brasov

The final day in Brasov is left free of planned activities for relaxation or independent plans. [Meal: B](#)

### DAY 6 Brasov – Bucharest

After breakfast return to Bucharest by coach, traveling through the Carpathian Mountains. Stop in Sinaia, known as the 'Pearl of the Carpathians' and home to one of Romania's most beautiful palaces – Peles Castle. A tour of the palace showcases some of its opulent decor and invaluable collections of art and furniture. Lunch is included during the excursion before arriving in Bucharest for an overnight. [Meals: B, L](#)

### DAY 7 Bucharest / Giurgiu, Romania

Begin the day with a guided city tour where you learn about some of Bucharest's highlights as the coach takes you on a panoramic drive. See the iconic Palace of Parliament and Triumph Arch. Visit the Spring Palace, former mansion of Nicolae Ceaușescu. Spared from the 1989 uprising that overthrew the dictator, the rooms exude opulence and remain as they were over 30 years ago. Following the tour, enjoy free time for lunch on your own. Journey by coach from Bucharest to Giurgiu, on the banks of the Danube, where a warm welcome awaits from your Captain and crew onboard your Emerald Cruises Star-Ship. The ship sails to Rousse this evening. [Meals: B, D](#)

### DAY 8 Rousse, Bulgaria

After arrival in Rousse, depart on an included walking tour. A local guide will tell about the city's history and point out some of the highlights. [Meals: B, L, D](#)

### DAY 9 Vidin, Bulgaria

A morning arrival brings you to Vidin in northwest Bulgaria. One of the oldest towns along the Bulgarian Danube, it prospers from its surrounding countryside, renowned for wine production. The day begins with an included tour of a vineyard and the opportunity to sample the local vintage. After a picturesque drive through the Bulgarian countryside, arrive at the medieval Baba Vida Fortress. During the guided tour, see the three fully-preserved towers and original battlements of the city's main attraction. Alternatively, embark on a hike to Belogradchik Fortress, also known as Kalet, on the northern slopes of the Balkan Mountains.



Belgrade, Serbia

Initially used as a lookout point, it is believed to have been built by Romans, utilizing the already existing rocky landscape. Meals: B, L, D

#### DAY 10 Donji Milanovac – Golubac, Serbia / Iron Gates

Embark on an incredible journey to the archaeological excavation site of Lepinski Vir. Located on the Danube in the Djerdap Gorge, near the town of Donji Milanovac, this Paleolithic site showcases a history spanning more than 8 millennia. Archaeologists have used this site to track the development of prehistoric culture in Europe and numerous Stone Age settlements have been found in the area. Re-embark the ship in Golubac following the excursion and enjoy the rest of the day sailing along the Danube River. Be sure to be on deck as you sail through the Iron Gates - the narrow gorge between the European Alps and Carpathian Mountains, boasting spectacular scenery.

Meals: B, L, D

#### DAY 11 Belgrade

Today's adventure begins with a guided walking tour of this vibrant capital city, showcasing the historic and architectural aspects. Alternatively, learn about the history of Belgrade during a guided bike tour of the city. After dinner, you're in for a treat as a dance troupe comes aboard and performs a folklore show featuring dances from various parts of the country. Meals: B, L, D

#### DAY 12 Vukovar, Croatia

Enjoy the morning in Vukovar or explore the Vucedol Culture Museum on the DiscoverMORE excursion. This afternoon, for a truly life-enriching experience, you are taken to the homes of local villagers for a home-hosted lunch. Enjoy this fantastic opportunity to share a typical meal with them and learn about their life, local culture, and customs. It's sure to be a highlight of your cruise! Meals: B, L, D

#### DAY 13 Ordas, Hungary / Budapest

This morning, the ship arrives in Ordas. Visit a local Pusztas Horse Farm during an included excursion. Watch a performance showcasing the exceptional riding skills of Magyar cowboys and the "tricks" of the horses themselves. Reboard the ship and enjoy your final afternoon onboard sailing to Budapest. Be sure to be on deck this evening as the ship arrives in Budapest to witness the beauty of the city aglow in nighttime splendor. Meals: B, L, D

#### DAY 14 Budapest / USA

Bid a fond farewell to Eastern Europe as you depart on the transfer to the airport and return home with memories of life-enriching experiences from your cruise along the lower Danube River. Meal: B



### EXCEPTIONAL INCLUSIONS

- 27 Meals: 12 breakfasts, 8 lunches and 7 dinners
- Airport transfers on tour dates when air is provided by Mayflower Cruises & Tours
- Visit five countries
- Three-night hotel stay and touring in Brasov, Romania
- Visits to Dracula's Castle and Peles Castle
- Two-night hotel stay and touring in Bucharest, Romania
- Seven-night cruise aboard a luxurious Emerald Cruises Star-Ship
- First-class service by an English-speaking crew
- Onboard Activity Manager will support all EmeraldACTIVE excursions and host daily onboard wellness activities, games, classes and evening entertainment
- Shore excursions with English-speaking local guides
- Personal listening device for shore excursions
- Onboard meals include a variety of international cuisine
- Complimentary regional wines, beer and soft drinks accompany onboard lunches and dinners
- Complimentary bottled water in your stateroom
- Complimentary WiFi onboard
- Complimentary bicycles onboard for use ashore
- All gratuities included

Itinerary and excursions are subject to change.

Additional excursions will be released approximately 180 days prior to departure.

### CRUISE AND HOTEL ACCOMMODATIONS

Day 2 – Radisson Blu, or similar, Bucharest, Romania

Days 3 through 5 – Hotel Ambient, or similar, Brasov, Romania

Day 6 – Radisson Blu, Bucharest, or similar, Romania

Days 7 through 13 – aboard an Emerald Cruises Star-Ship

# EMERALD STAR-SHIPS

Built: 2014-2026 Cabins: 91 Guests: 180 Length: 443 ft. Crew: 52

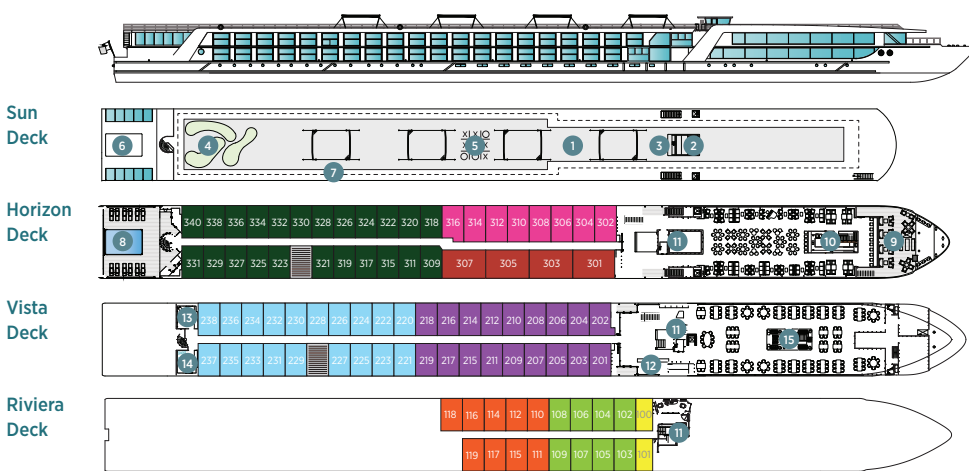

- 1 Sun Deck with Deck Chairs\*
- 2 Navigation Bridge
- 3 Sky Barbecue
- 4 Golf Putting Green
- 5 Games Area
- 6 Retractable Glass Roof
- 7 Walking Track
- 8 Daytime Pool & Bar/Evening Cinema
- 9 The Terrace
- 10 Horizon Bar & Lounge
- 11 Lift
- 12 Reception
- 13 Wellness Area
- 14 Fitness Area
- 15 Reflections Restaurant

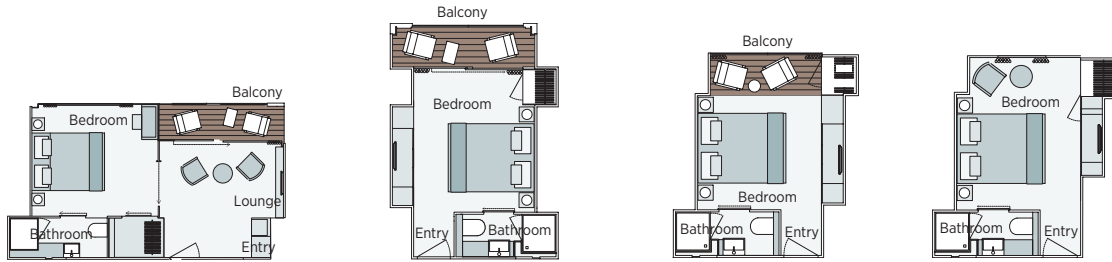

**Owner's One-Bedroom Suite**  
285ft<sup>2</sup> – 315ft<sup>2</sup>

CAT SA

**Grand Balcony Suite**  
207ft<sup>2</sup> – 210ft<sup>2</sup>

CAT S

**Emerald Panorama Balcony Suite**  
160ft<sup>2</sup> – 189ft<sup>2</sup>

CAT A CAT B CAT C

**Emerald Stateroom**  
153ft<sup>2</sup> – 170ft<sup>2</sup>

CAT D CAT E

**Important Information:** The cabin and deck plans, sizes and photographs are an indication only and are subject to variation. \* Due to safety, the Sun Deck will be closed when travelling under low bridges.

Tour Code 804PC 2027 Departure Dates	RIVIERA DECK		VISTA DECK		HORIZON DECK		HORIZON DECK		HORIZON DECK	
	CAT E, D		CAT C, B		CAT A		CAT S		CAT SA	
	PER PERSON TWIN	SINGLE ROOM	PER PERSON TWIN	SINGLE ROOM	PER PERSON TWIN	SINGLE ROOM	PER PERSON TWIN	SINGLE ROOM	PER PERSON TWIN	SINGLE ROOM
June 6	\$7,071	+ \$5,168	\$8,147	+ \$5,975	\$8,660	+ \$6,360	\$9,456	N/A	\$10,558	N/A

**Land/cruise, roundtrip DSM airfare, hotel baggage handling, local beer and wine with lunches and dinners, all gratuities to guides, drivers and ship staff and Hosted by Angela and Sonja!**

Air itineraries may not be available until documents are received. Air seats are assigned by the airline for the entire group and may not be available until airport check-in. Seat changes can only be attempted at the airport and may not be possible. If specific seat assignments are vital to your reservation, we recommend booking air on your own rather than booking air with the group.



**Travelers Protection Plan (TPP) for River Cruises – \$569 (optional)**

This nonrefundable fee will provide a refund to you during the instance that you have to cancel your trip. The cancellation has to be for a covered reason (see Plan for details on coverage) and we have to be notified at least one day prior to departure. If you must leave the tour early due to personal illness or the illness or death of an immediate family member, TPP will provide a refund for any unused services after the departure of the tour. Other benefits include medical expenses for illness and injury, emergency transportation, 24 hour hot line and lost or stolen baggage assistance. Return air transportation is included ONLY if your air tickets are purchased through Mayflower Cruises & Tours. Please review the Plan for details on coverage. Should you choose not to purchase our TPP, the following per person cancellation charges will be assessed for all tours and optional excursion costs:

- 121 days or more prior to departure: Deposit Amount
- 120 days to day of departure: 100% of total tour
- No refund on unused portions of the tour

Exclusions: Mayflower Cruises & Tours reserves the right to alter its Refund and Cancellation Policy when a substantial amount of cancellation or postponement of travel is attributable to: conditions resulting from an act of God, natural or man-made disaster, fire, government action, civil disorder, war, hostilities between nations, or unavailability of transportation through no fault of Mayflower Cruises & Tours. Plan and benefits offered and administered by Trip Mate, Inc.

FOR RESERVATIONS OR INFORMATION CONTACT:

**CSB Select 50**  
**(515) 252-7587**



Angela



Sonja

Select50@bankcsb.com



# RESERVATION FORM – EMERALD RIVER CRUISING



Tour: \_\_\_\_\_ Departure Date: \_\_\_\_\_

Group Name: \_\_\_\_\_ Group Number: \_\_\_\_\_

For Reservations Contact: \_\_\_\_\_

**IMPORTANT:** Please print your name **EXACTLY** as it appears on your **passport**. We require a copy of your passport at the time of initial reservation or no later than two (2) weeks after making your reservation. Name corrections, after final payment due date, or after tickets have been issued, will result in additional fees being assessed.

Today's Date: \_\_\_\_\_

**YOUR INFORMATION:** (Please print your name **EXACTLY** as it appears on your passport)

First: \_\_\_\_\_ Middle: \_\_\_\_\_ Last: \_\_\_\_\_ Suffix: \_\_\_\_\_

Salutation (Mr., Mrs., Rev): \_\_\_\_\_ Preferred name on nametag: \_\_\_\_\_

Address: \_\_\_\_\_ City: \_\_\_\_\_ State: \_\_\_\_\_ Zip Code: \_\_\_\_\_

Phone: \_\_\_\_\_ Cell: \_\_\_\_\_ Email Address: \_\_\_\_\_

Passport Number: \_\_\_\_\_ Date of Issue (m/d/y): \_\_\_\_\_ Date of Expiration (m/d/y): \_\_\_\_\_

Place of Issue (Authority): \_\_\_\_\_ Nationality: \_\_\_\_\_ Global Entry/TSA # \_\_\_\_\_

Date of Birth (m/d/y): \_\_\_\_\_ Place of Birth: \_\_\_\_\_ Gender:  Male  Female

Passport photo page attached/included with reservation form.

**EMERGENCY CONTACT:** (Please provide contact information of person **NOT** traveling with you)

Name: \_\_\_\_\_ Relationship: \_\_\_\_\_

Cell Phone #: \_\_\_\_\_ Home Phone #: \_\_\_\_\_

## AIR AND ROOMING INFORMATION:

Departure airport: \_\_\_\_\_  Mayflower Air  Writing Own Air

Food Allergies or Special Dietary Requirements:  Yes  No

Are you bringing a Sleep Apnea Machine:  Yes  No

Are you bringing any Mobility Aids:  Yes  No

(If you checked YES to any of the above, you are required to fill out the corresponding information form.)

## ROOM CATEGORY:

**Single** (Select  one bed *or*  two beds)  **Twin** (two beds)  **Double** (one bed)  **Guaranteed Share\***

\*Mayflower's Guaranteed Share Program is available on the Riviera, Vista and Horizon Decks standard staterooms only.

## STATEROOM CATEGORY:

Riviera Deck (CAT E)  Riviera Deck (CAT D)  Vista Deck (CAT C)  Vista Deck (CAT B)  Horizon Deck

Grand Balcony Suite  Owners Suite

Requested Cabin #: \_\_\_\_\_ 1<sup>st</sup> Preference #: \_\_\_\_\_ 2<sup>nd</sup> Preference #: \_\_\_\_\_ 3<sup>rd</sup> Preference #: \_\_\_\_\_

We will make every effort to accommodate your preference of cabin category. All cabins are on a first come first reserve basis.

Rooming with: \_\_\_\_\_ **Please complete separate reservation form for traveling companion.**

## PAYMENT INFORMATION:

**By placing a deposit, you understand and accept the terms and conditions of Mayflower Cruises and Tours and Scenic Group. For details of the Scenic Group terms please visit <https://www.emeraldcrucises.com/terms-conditions>**

Purchasing Travelers Protection Plan (TPP):  Yes  No

Cruise price up to \$5000: TPP \$ \_\_\_\_\_ Cruise price \$5001 and up: TPP \$ \_\_\_\_\_

Deposit Amount: \$ \_\_\_\_\_ + Travelers Protection Plan: \$ \_\_\_\_\_ = Total Amount Enclosed: \$ \_\_\_\_\_

Final Payment Due By: \_\_\_\_\_ Make Checks Payable To: \_\_\_\_\_

Mail Deposit To: \_\_\_\_\_ City: \_\_\_\_\_ State: \_\_\_\_\_ Zip Code: \_\_\_\_\_

Mail Final Payment To: \_\_\_\_\_ City: \_\_\_\_\_ State: \_\_\_\_\_ Zip Code: \_\_\_\_\_

## CREDIT CARD INFORMATION:

If you would like to make your deposit by credit card, please provide the information to your group leader who will make your payment directly to Mayflower. VISA, MC, and Discover are accepted.

# 2027 RIVER CRUISING & SMALL SHIP ADVENTURES

## Booking Conditions

**Payments:** All deposits and final payments can be made by check or credit card. We accept the following credit cards: Visa, MasterCard and Discover.

**Prices Subject to Change:** We reserve the right to vary itineraries and prices and substitute facilities, hotels or events of equal or better quality if necessary.

**Guaranteed Share Program for Single Travelers:** If you are traveling alone and would like a roommate for cost savings, let us know at the time of booking your reservation. Travelers must be non-smokers, cannot use a medical sleeping device or have specific needs like Handicapped room etc. to be eligible. Participants will be paired with another traveler of the same gender at the twin rate. If no roommate is available, you will get a single room at the twin rate. Guaranteed share reservations are available up to 180 days prior to tour departure. Guaranteed share reservations are only available on certain Cabin categories. Please call us for details.

**Roommate Cancellation:** If you are booked as a "twin" and your roommate cancels their reservation, and you cannot find another roommate, you may either travel as a guaranteed share (see above) or travel as a single and pay the single supplement.

**Health and Walking on Tour:** Some sites visited have limited motorcoach access and may involve considerable walking, stairs or inclines. Travelers should be in reasonably good health. Some programs include destinations in higher elevations that may have varying effects on individual travelers. Tour Managers and Coach Drivers cannot lift or assist travelers into transportation vehicles. Mayflower Cruises & Tours requires that persons requiring assistance be accompanied by a companion who is capable of and totally responsible for providing the assistance.

**Revision Fees:** A fee of \$25 per person per transaction will be charged for any changes, revisions or alterations made to your reservation after confirmation.

**Luggage Handling:** The tour cost includes portage for one average size suitcase. A charge of \$5.00 per hotel will be collected by the Tour Manager for each additional piece of luggage that you bring.

**Travel Documents:** Your travel documents will be in your possession approximately 14 days prior to departure. Documents include tour itinerary, departure and arrival information and times, hotel and ship information, clothing suggestions, baggage tags, plus any helpful hints.

**Mayflower Loyalty Program:** Earn \$150 travel credit for every River Cruise and Small Ship Adventure taken with Mayflower Cruises & Tours. No restrictions on the amount of credits an individual can acquire. Loyalty Credits can be applied to any reservation made within one year of the return of the tour they were earned on. Multiple credits can be used on a single tour. Credits are nontransferable but can be combined with Mayflower promotional savings. Some restrictions apply, call for details.

**Smoke Free Environment:** All river cruise vessels have a no-smoking policy inside the vessel. There may be designated smoking areas outside on certain decks, and any smoking must be done in the designated areas only. While on the excursions, there is no smoking allowed on the motorcoach.

**Travelers with Special Needs:** You must advise Mayflower at the time your booking is made of any disability requiring special attention. Mayflower will make reasonable efforts to accommodate the special needs of our travelers. Be aware that the Americans with Disabilities Act is applicable only within the United States and that accommodations for disabled travelers outside the United States may be more limited. If a traveler requires assistance, we require that he/she be accompanied by a companion who is capable of and totally responsible for providing the assistance. Neither Mayflower personnel, nor its suppliers, may lift or physically assist travelers. If a traveler thinks he/she might need assistance during a trip, he/she should call Mayflower to determine what assistance might reasonably be provided. If special arrangements are provided, and these arrangements add to the Tour Operator's cost, the Tour Member will be responsible to pay the additional costs. Mayflower cannot provide special individual assistance to travelers with special needs for walking, dining or other routine activities. Travelers requesting

a handicapped room cannot be booked with Guaranteed Share accommodations.

**Membership:** Mayflower reserves the right to withhold tour membership, or to require any traveler to leave a tour at any time, when such action is determined by Mayflower to be in the best interests of the traveler or the tour group. Children must be at least 12 years of age and accompanied by a guardian at all times.

**Force Majeure:** Except where otherwise expressly stated in these terms and conditions we cannot accept liability or pay any compensation where the performance or prompt performance of our obligations under our contract with you is prevented or affected by or you otherwise suffer any damage, loss or expense of any nature as a result of Force Majeure. "Force Majeure" means any event which we or the supplier of the services in question could not, even with all due care, foresee or avoid.

**Responsibility:** These tour programs are operated by Mayflower Cruises & Tours, Inc. 650 Warrenville Rd, Suite 500, Lisle, IL 60532. In common with other companies, Mayflower acts only as an agent for Tour Members in arranging room accommodations, transportation, sightseeing, admissions and restaurants. Mayflower reserves the right in its sole discretion to make changes in the itinerary and is not responsible for expenses, loss of time, money or other occurrence resulting from a change of tour scheduling made for Tour Members. Mayflower reserves the right to accept, decline or retain any person as a member of the tour, and is not responsible for any losses or damages of personal property, or for injuries, expenses or damages incurred by any Tour Member.

### United States Tour Operators Association \$1 Million Travelers Assistance Program

Mayflower Cruises & Tours, Inc. shares the coverage available under the United States Tour Operators Association ("USTOA") \$1 Million Travelers Assistance Program with affiliates of Mayflower Cruises & Tours who, as an Active Member of the USTOA is required to post \$1 Million with USTOA to be used to reimburse, in accordance with the terms and conditions of the USTOA Travelers Assistance Program, the advance payments of Mayflower Cruises & Tours travelers in the unlikely event of Mayflower Cruises & Tours bankruptcy, insolvency or cessation of business. Further, you should understand that the \$1 Million posted by Mayflower Cruises & Tours may be sufficient to provide only a partial recovery of the advance payments received by Mayflower Cruises & Tours. Complete details of the USTOA Travelers Assistance Program and a list of affiliates may be obtained by writing to USTOA at 345 Seventh Avenue, Suite 1801, New York, NY 10001, or by email to [information@ustoa.com](mailto:information@ustoa.com) or by visiting [www.ustoa.com](http://www.ustoa.com).

**Airline Security Measures:** The Transportation Security Administration requires that travelers provide their name exactly to their airline as it appears on their passport to be used while traveling, along with their date of birth and gender when making reservations to fly from the U.S. When making your flight reservations through Mayflower Cruises & Tours, you will be asked for this information by our staff. Due to airline security measures, your passport must match your airline ticket name and your tour reservation name or you may be denied aircraft boarding.

**Passport & Visas:** Each U.S. citizen must have a valid passport. Expiration date of passport should be at least six months after the return date of the tour. If you don't have a passport, call our office and we'll tell you how to apply for one. Some countries require visas for entry by U.S. citizens. We will send instructions for visa applications if a visa is required for your tour. Holders of non-U.S. passports should contact their nearest consulate and inquire about the necessary passport or visa documentation required for entry into the countries visited. Visa fees and cost of obtaining a visa are not included in the tour price and are the responsibility of the traveler.

**Medical Requirements:** Many countries have immunization requirements. Some countries require foreign visitors to have valid medical insurance on entry. Requirements vary by country and can change. Please check with your travel professional or call our office for details on which tours need these requirements. Specific instructions will be sent to you at 90 days prior to departure if your tour requires these conditions. Mayflower Cruises & Tours cannot be liable for delay or denial of entry due to missing documents.

**Itinerary Changes:** There may be times when we may have to alter the scheduled itinerary, cruise vessels, hotels, shore excursions etc. due to weather conditions or conditions on the river in regards to water levels, locks, or other delays. Any changes in the itinerary due to these conditions will not result in eligibility for a refund. All itineraries are subject to change without prior notice and may need to be altered due to water level and other weather conditions.

**Cruise:** (a) Noise, Vibration and Odor: While We take reasonable steps to minimize noise, vibrations and odors on the cruise ships, You acknowledge and accept that some noise, vibration and intermittent odors may be experienced on vessels and that We will not be liable to You in relation to any such noise, vibration or odors.

(b) Docking Position: During port stops, ships may dock side-by-side, obstructing views and requiring You to pass through other ships to embark and disembark.

### THE TRAVEL PROTECTION OFFERED FOR RIVER CRUISES THE F431G PLAN.

#### DEPOSIT SCHEDULE - SCENIC, EMERALD AND GALÁPAGOS LAND/ CRUISE TOUR PRICE UP TO \$5,000

Land/Cruise Tour with Air*	Deposit Per Person	Final Payment
• With TPP Coverage	\$899	120 Days
• Without TPP Coverage	\$400	120 Days
Land/Cruise Tour Only	Deposit Per Person	Final Payment
• With TPP Coverage	\$899	120 Days
• Without TPP Coverage	\$400	120 Days

#### DEPOSIT SCHEDULE - SCENIC, EMERALD AND GALÁPAGOS LAND/ CRUISE TOUR PRICE FROM \$5,001 AND UP

Land/Cruise Tour with Air*	Deposit Per Person	Final Payment
• With TPP Coverage	\$969	120 Days
• Without TPP Coverage	\$400	120 Days
Land/Cruise Tour Only	Deposit Per Person	Final Payment
• With TPP Coverage	\$969	120 Days
• Without TPP Coverage	\$400	120 Days

#### DEPOSIT SCHEDULE - TREASURES OF THE PHAROAH'S

Land/Cruise Tour with Air*	Deposit Per Person	Final Payment
• With TPP Coverage	\$899	120 Days
• Without TPP Coverage	\$400	120 Days
Land/Cruise Tour Only	Deposit Per Person	Final Payment
• With TPP Coverage	\$899	120 Days
• Without TPP Coverage	\$400	120 Days

#### DEPOSIT SCHEDULE - MAJESTIC MEKONG RIVER CRUISE; TREASURES & TEMPLES OF VIETNAM AND CAMBODIA; SPLENDORS OF EUROPE

Land/Cruise Tour with Air*	Deposit Per Person	Final Payment
• With TPP Coverage	\$969	120 Days
• Without TPP Coverage	\$400	120 Days
Land/Cruise Tour Only	Deposit Per Person	Final Payment
• With TPP Coverage	\$969	120 Days
• Without TPP Coverage	\$400	120 Days

\*Land tour price is based on twin occupancy rate

**Payment Information:** Listed above is a schedule of deposit and final payment due dates. You will note that the first category includes an optional Travelers Protection Plan (TPP). Within five business days of making your reservation, you must make your initial trip deposit. Once your trip deposit is made, you then have 24 hours to add on the Optional TPP if you choose to purchase. Please see "Travelers Protection Plan (TPP)" section in the next column for further explanation of this offering. By placing a deposit, you understand and accept the terms and conditions of Mayflower Cruises and Tours and Scenic Group. For details of the Scenic Group terms please visit <https://www.emeraldcrucises.com/terms-conditions>

**Refund and Cancellation Policy:** Payments for land, air, and cruise arrangements, (less the deposit amount) will be refunded when cancellations are received prior to the final payment due date noted above. Deposits are non-refundable unless the optional Travel Protection Plan (TPP) is purchased at the time of booking and you have a covered claim. The Refund and Cancellation Policy is offered by Mayflower Cruises and Tours and is separate from the Travel Protection Plan.