

**SPECIAL  
SAVINGS**  
WHEN BOOKED BY  
07/10/2024

# Tulip Time on the Rhine and Golden Pass Rail

Switzerland • France • Germany • the Netherlands

April 21 - May 3, 2025  
13 DAYS

 **Sun Tours**  
*Traveling the World Together*

# Tulip Time on the Rhine and Golden Pass Rail



Enjoy seven-nights cruising the Rhine River aboard an Emerald Star-Ship



Charming scenes abound in Strasbourg, France

**DAY 1 Depart the USA:** Depart the USA on your overnight flight to Geneva, Switzerland.

**DAY 2 Geneva – Lausanne, Switzerland:** Welcome to Switzerland! You will be met at the airport and transferred by coach to the beautiful city of Lausanne. Flights should arrive by 3:00pm. The remainder of the day is at leisure to begin exploring your new surroundings. Enjoy an included dinner this evening at the hotel. **Meal: D**

**DAY 3 Lausanne:** Begin the day with a panoramic tour of the city, known around the world for its spectacular setting, and home of the International Olympic Committee and Museum. This afternoon, visit Château de Chillon, one of Europe's best-preserved medieval castles, on the shores of Lake Geneva. Surrounded by breathtaking scenery, discover the history of this 13th-century fortress. Learn about the château's association with famous authors and artists; the counts and dukes who inhabited it as well as the prisoners who occupied the jail; see period furnishings, art treasures and frescoes. The beauty of the area continues to amaze during a cruise on Lake Geneva from the harbor in Montreux. Relax onboard as the spectacular scenery unfolds while sailing back to Lausanne before returning to the hotel. **Meal: B**

**DAY 4 Lausanne / Golden Pass:** Today may be a highlight of your time in Switzerland as you experience a unique rail journey and mountain adventure. Depart by coach to Montreux where it's 'all aboard' the Golden Pass for an unforgettable panoramic train ride through the scenic landscapes of the Alps. Disembark the train in Gstaad where the coach is waiting to take you to Col du Pillon for the Glacier 3000 mountain adventure. Ascend via arial cable car to an altitude of approximately 9850' above sea level where you are met with astounding panoramic views, including the Matterhorn and Jungfrau. Walk across the world's first suspension bridge connecting two mountain summits, if you dare! Return to the hotel in Lausanne this afternoon. **Meals: B, D**

**DAY 5 Lausanne:** The day is left free of planned activities for your independent exploration. If you prefer, join an optional excursion to visit the village of Gruyère (famous for cheese-making) and Maison Cailler Chocolate Factory. **Meal: B**

**DiscoverMORE:** Visit to Gruyère and Maison Cailler Chocolate Factory (additional expense)

**DAY 6 Lausanne - Basel:** After breakfast, depart Lausanne and travel by coach to Basel for embarkation of the Emerald Cruises Star-Ship and start of the cruise along the Rhine River. Settle into your stateroom and enjoy your first meal onboard at dinner this evening. **Meals: B, D**

**DAY 7 Breisach, Germany:** Experience the 'tale of two cities': Breisach, Germany and Neuf-Breisach, France, divided by the Rhine. During the guided visit to these two wonderful gems on the Rhine River, you'll pass the main sights and attractions, including the UNESCO World Heritage fortress overlooking Neuf-Breisach. This evening, enjoy local entertainment onboard. **Meals: B, L, D**  
**EmeraldPLUS:** A tale of two cities divided by the Rhine  
**EmeraldACTIVE:** Guided bike tour in Breisach

**DAY 8 Strasbourg, France:** Once docked in Kehl, coaches await to take you across the river to Strasbourg, the capital city of the Alsace Region in France. The guided walking tour takes you along narrow lanes and across footbridges as you discover the Grande Île, the historical city center and UNESCO World Heritage Site. Known for its medieval black and white timber-framed buildings, picturesque le Petite France, old tanning houses, canals and river locks, the city's star attraction is the ornate cathedral, dominating the main square. This afternoon, the city is yours to explore at leisure. **Meals: B, L, D**

**DAY 9 Ludwigshafen, Germany – Schwetzingen:** Relax onboard as the vessel cruises along the Rhine River to Ludwigshafen. Upon arrival travel by coach to visit Schwetzingen Palace, famous for the beauty and harmony of its gardens. Visit the interior of the palace, along with the beautiful gardens, maintained in their original design. Today they remain a cultural heritage site of European significance, and contain more than 100 sculptures scattered throughout the grounds. Alternatively, embark on an active journey to the quaint wellness town of Bad-Dürkheim for a hike through the beautiful vineyards. Enjoy local entertainment onboard this evening. **Meals: B, L, D**  
**EmeraldPLUS:** Visit to Schwetzingen Palace & Gardens  
**EmeraldACTIVE:** Guided vineyard hike in Bad-Dürkheim (instead of included tour)

**DAY 10 Koblenz:** Begin the day sailing through the spectacular UNESCO World Heritage Rhine Gorge. Pass countless medieval



Flowers and fragrances fill Keukenhof Gardens

castles and vineyards lining the shores of this section of the river, with photo opportunities around every bend. See the infamous Lorelei statue and Pfalzgrafenstein Castle, built on an island in the middle of the river as a medieval toll station. Continue cruising to the 2000-year-old town of Koblenz, situated at the confluence of the Rhine and Moselle Rivers. Enjoy a walking tour of Koblenz seeing the German Corner where the 2 rivers meet, the Church of Our Lady, and visit the Ehrenbreitstein Fortress by cable car on the opposite side of the river. This fortress was part of the Prussian defense against the French in the 19th century and later used as a headquarters for the American military during WWII. **Meals: B, L, D**  
**DiscoverMORE:** Moselle & Cochem (Reichsburg) Castle Visit (additional expense)

**DAY 11 Cologne:** Continue cruising along the Rhine River to Cologne. Founded by the Romans, the city is one of Germany's oldest and is famous for its magnificent UNESCO World Heritage gothic cathedral. Join your local guide for an included walking tour of the city, touching on the historical charm of the Old Town and its Roman history. Traverse the quaint alleyways and see historic monuments alongside modern architecture. The tour concludes at the cathedral, whose twin spires dominate the skyline. A visit to Cologne Botanical Gardens showcases local flora. This evening, back onboard, join your Captain for a farewell reception and dinner. **Meals: B, L, D**

**DAY 12 Amsterdam, the Netherlands:** This morning, depart by coach for an included visit to the world-famous Keukenhof Gardens. Discover why it's called the "Garden of Europe" as you wander along the paths, admiring gorgeous flowers at the peak of tulip season. Unique flower shows in the pavilions along with colorful, artistic floral displays throughout the manicured garden, are sure to please! Return to the ship in the afternoon to explore the city of Amsterdam at your leisure. **Meals: B, L, D**

**DAY 13 Amsterdam / USA:** Bid 'auf wiedersehen' to Europe and return home with memories of life enriching experiences from your European adventure and cruise along the Rhine River during tulip time. **Meal: B**

Itinerary is subject to change.



## Exceptional Inclusions

- **25 Meals:** 11 breakfasts, 6 lunches and 8 dinners
- **Airport transfers** on tour dates when air is provided by Mayflower Cruises & Tours
- Visit **four countries**
- Four-night hotel stay and touring in Lausanne
- Visit to **Château de Chillon** on Lake Geneva
- **Cruise on Lake Geneva**
- Scenic journey aboard the **Golden Pass Railway**
- **Glacier 3000** Mountain Adventure
- **Seven-nights in a suite or stateroom** of your choice onboard the vessel
- **First-class service** by an English-speaking crew
- **All gratuities included**
- Explore the magnificent **Keukenhof Gardens**
- **Shore excursions** with English-speaking local guides
- Visit **UNESCO World Heritage Sites**
- Personal **listening device** for shore excursions
- **All meals included** onboard
- Variety of **international cuisine**
- Complimentary **regional wines, beer and soft drinks** with onboard lunches and dinners
- **Onboard Activity Manager** will support all EmeraldACTIVE excursions and host daily onboard wellness activities, games, classes and evening entertainment
- Complimentary **bottled water** in your stateroom
- Complimentary **WiFi onboard**
- Complimentary **bicycles onboard** for use ashore
- **All port charges included**

## CRUISE AND HOTEL ACCOMMODATIONS

**Days 2 through 5** – Movenpick Hotel or similar, Lausanne, Switzerland

**Days 6 through 12** – Aboard an Emerald Cruises Star-Ship  
 Post-cruise hotel stays available in Amsterdam. Call for details.

# Emerald Cruises Star-Ships

**Built:** 2014-20 **Speed:** 15.5 mph **Staterooms:** 19 **Suites:** 72 **Length:** 443 ft. **Crew:** 47

## SUN DECK



## HORIZON DECK



## VISTA DECK



## RIVIERA DECK



## Public Areas and Ship Amenities

- 1 Sun Deck with Deck Chairs
- 2 Navigation Bridge
- 3 Sky Barbeque
- 4 Golf Putting Green
- 5 Games Area
- 6 Retractable Glass Roof
- 7 Walking Track
- 8 Daytime Pool / Evening Cinema
- 9 The Terrace
- 10 Horizon Bar and Lounge
- 11 Elevator
- 12 Reception
- 13 Wellness Area
- 14 Fitness Area
- 15 Reflections Restaurant



**Owner's One-Bedroom Suite**

315ft<sup>2</sup>

CAT SA



**Grand Balcony Suite**

210ft<sup>2</sup>

CAT S



**Panorama Balcony Suite**

180ft<sup>2</sup>

CAT A CAT B CAT C

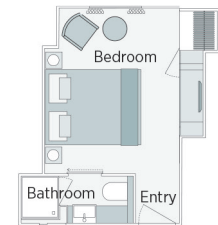

**Emerald Stateroom**

162ft<sup>2</sup>

CAT D CAT E

## Tulip Time Cruise on the Rhine and Golden Pass Rail

**Dates:** April 21 - May 3, 2025 (13 Days)

**SAVE UP TO \$1,000 PER PERSON WHEN BOOKED BY 07/10/2024**

**Deposits: 20%\* per person NOW holds your place**  
\*Percentage of total price

**FINAL PAYMENT DATE:** DECEMBER 03, 2024

### CANCELLATION FEES:

\$400 now – JANUARY 15, 2025 100% After – JANUARY 15, 2025

### Price Includes:

- ✓ Roundtrip Airfare from ABQ
- ✓ First-class service and tours from an English-speaking crew and knowledgeable local guides
- ✓ All Gratuities Included (except hotel housekeeping)
- ✓ Deluxe hotels with all service charges, taxes and portage included
- ✓ Government Fees, Port & Air Taxes
- ✓ Complimentary Wi-Fi
- ✓ Your SUN TOURS Escort (with 15 or more travelers)

CAT	STATEROOM / SUITE	DECK	APRIL 21, 2025	
			FULL FARE PER PERSON TWIN	EARLY BIRD PER PERSON TWIN
E	Emerald Stateroom	Riviera	\$8,855	\$7,855
D	Emerald Stateroom	Riviera	\$9,195	\$8,195
C	Panorama Balcony Suite	Vista	\$9,935	\$8,935
B	Panorama Balcony Suite	Vista	\$10,135	\$9,135
A	Panorama Balcony Suite	Horizon	\$10,275	\$9,275
S	Grand Balcony Suite	Horizon	\$11,015	\$10,015
SA	Owner's One-Bedroom Suite	Horizon	\$12,035	\$11,035

Please call for single occupancy pricing.

FOR RESERVATIONS OR INFORMATION CONTACT:



1700 Louisiana NE, Suite 100  
Albuquerque, NM 87110

**505-889-8888**

www.SunToursUS.com  
service@SunToursUS.com